

Advanced Features

- Convert to Formula
- Filter component

Convert to Formula

By converting all the fields in the crosstab into formulas, all the objects in the crosstab are deleted. The result values called from the server with the formula are still displayed in the table.

In formula mode, you can use all Microsoft Excel formatting functions. With the deletion of the design item, the individual formatting of the data will not be overwritten by the standard formatting in the crosstab the next time you update this data.

Text that is normally not displayed because it occurs several times in a row or column, is now repeated in each cell automatically to produce valid formulas.

Advantages with convert to formula

1. Create persistent individual cell
2. Insert blank rows or columns to make the display easier to read
3. Copy parts of the table to other cells in the workbook
4. Use data from multiple data providers when creating calculations

Consequences with convert to Formula

1. Navigation with Drag & Drop is no longer possible
2. The context menu is not available
3. The number format in the cells is set to standard
4. The conversion can only be undone from the analysis ribbon
5. If the crosstab is saved, it cannot be converted back to analysis mode

Add Additional Information via Formula

1. Click the cell outside the crosstab and click the insert button
2. Select Analysis for the "Category" and choose a function in the Pop up
3. Select a data source to apply the Formula. Type DS_1 the default data source formula Alias

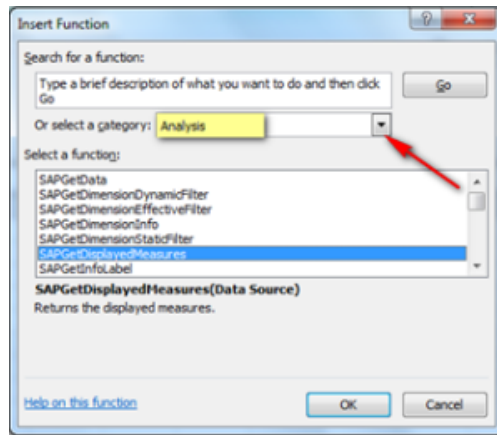

Alternatively, use the drag and drop solution :

1. Click the Display tab and select "Information tab"
2. Drag and drop any information from the Design Panel Information tab into an empty cell then save your workbook.

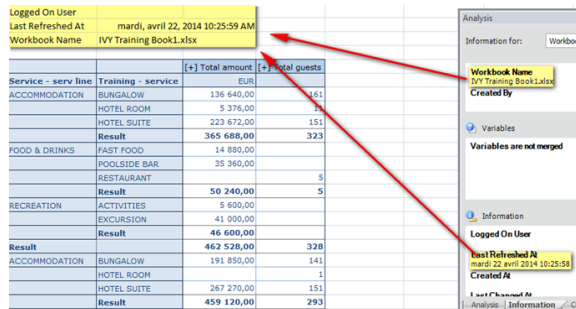

Filter component

You can add a special cell in the workbook which allows you to dynamically add filters on a dimension.

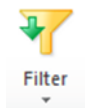

1. Click a cell **outside** a crosstab
2. Click "Filter" tab and select a dimension (Note that this filter selection has a green **arrow**)
3. Click the Filter Icon to change your filter

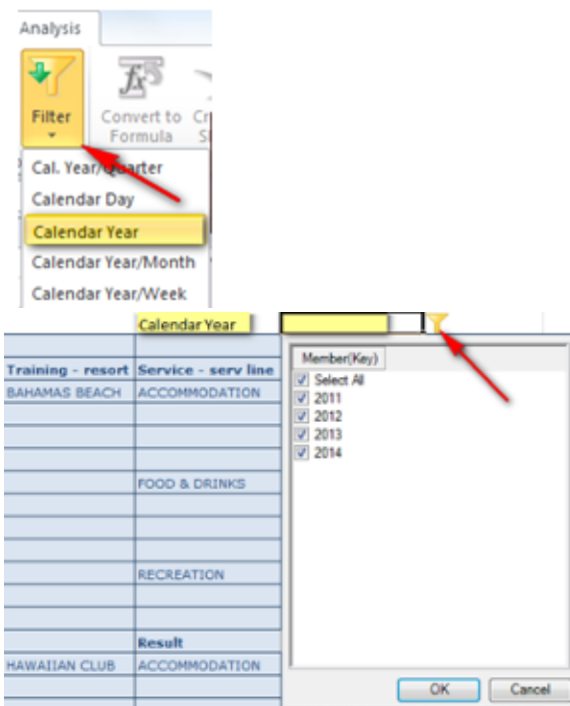

Related Information

- [BW - FAQ](#)