

Appspace (application administrator): create a channel by file import

Introduction

In Appspace is not possible to duplicate a channel in another network.

If you to create a channel based on the common template you have to export a channel (model) in a file and then import it in another Network.

This procedure explains how to import a channel from a file.

[Appspace \(application administrator\): export channel in a file to duplicate it by import](#)

Actions

Go to to the network and then to the channels home page.

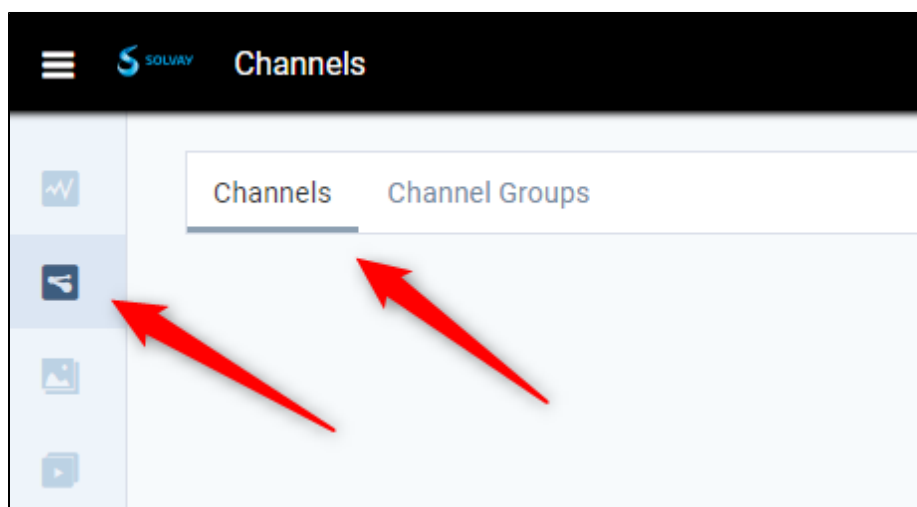

Click on **CREATE CHANNEL**:

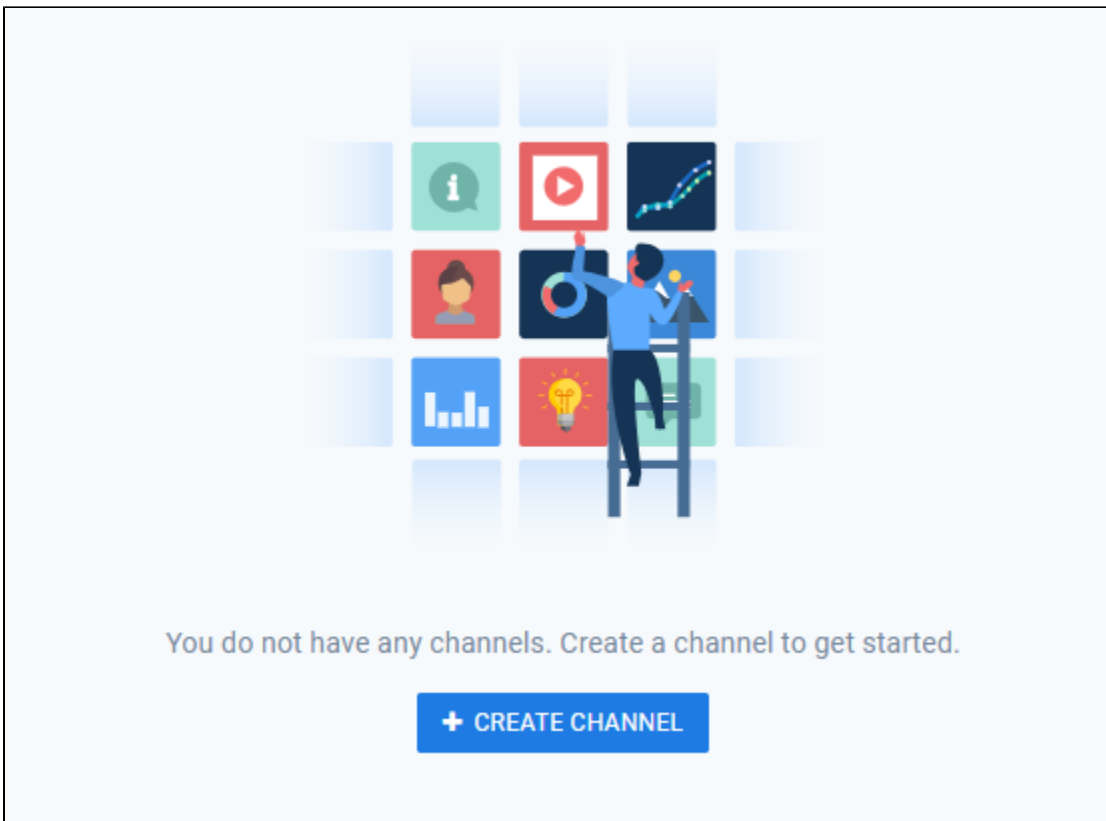

Click on **IMPORT** in the box **Create an advanced channel**:

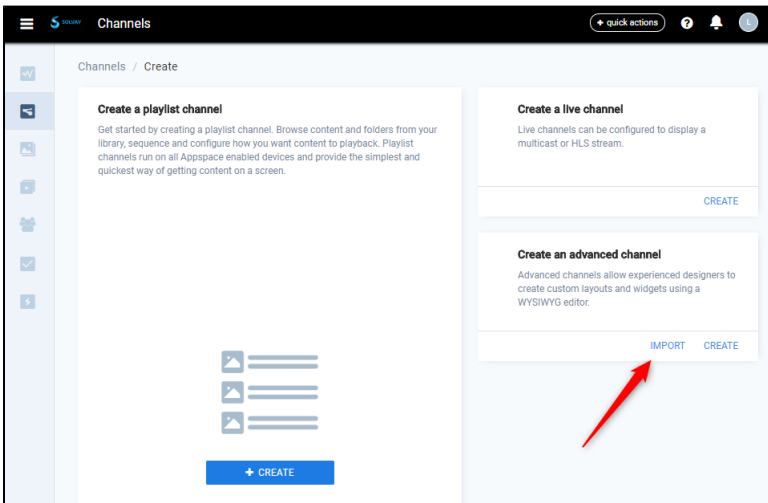

Select the file, give a name to the channel and click on OK:

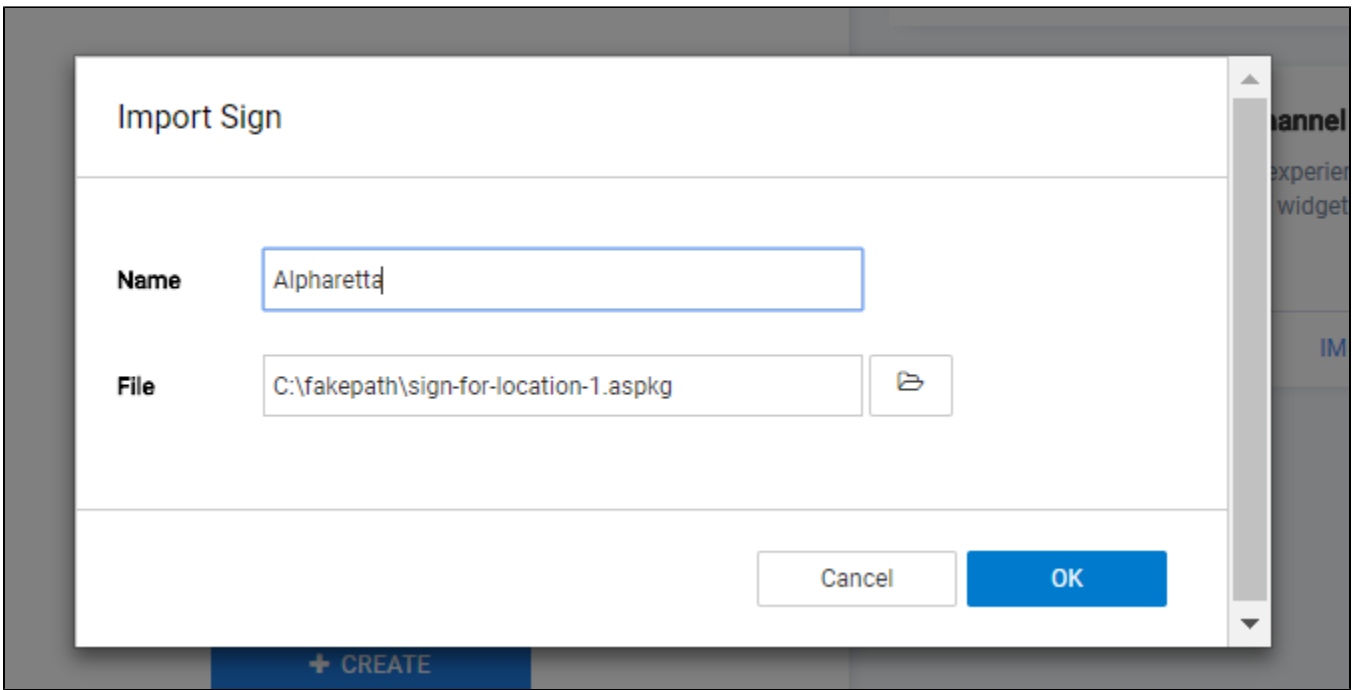

Warning

After import, you have to add all the widgets (Weather, Stock quote, Traffic) from Corporate library. These widgets are not kep.