

Load data from gSheet

- Go to your gSheet you want to integrate in qlik sense

example : (https://drive.google.com/file/d/1jzXm8k_96GbaSW7iQ9-gmlWREWbwV3c73fVJGM0YBpw/view or <https://drive.google.com/file/d/1u-jBgJb1Zch7DpoOTYVt4KifGAzm6717p6EXSqoF8s/view>)

- Add sbs-is-appli-qlikview.support@solvay.com with reader access right on the spreadsheet

blocked URL

Please share the gSheet to the good service account

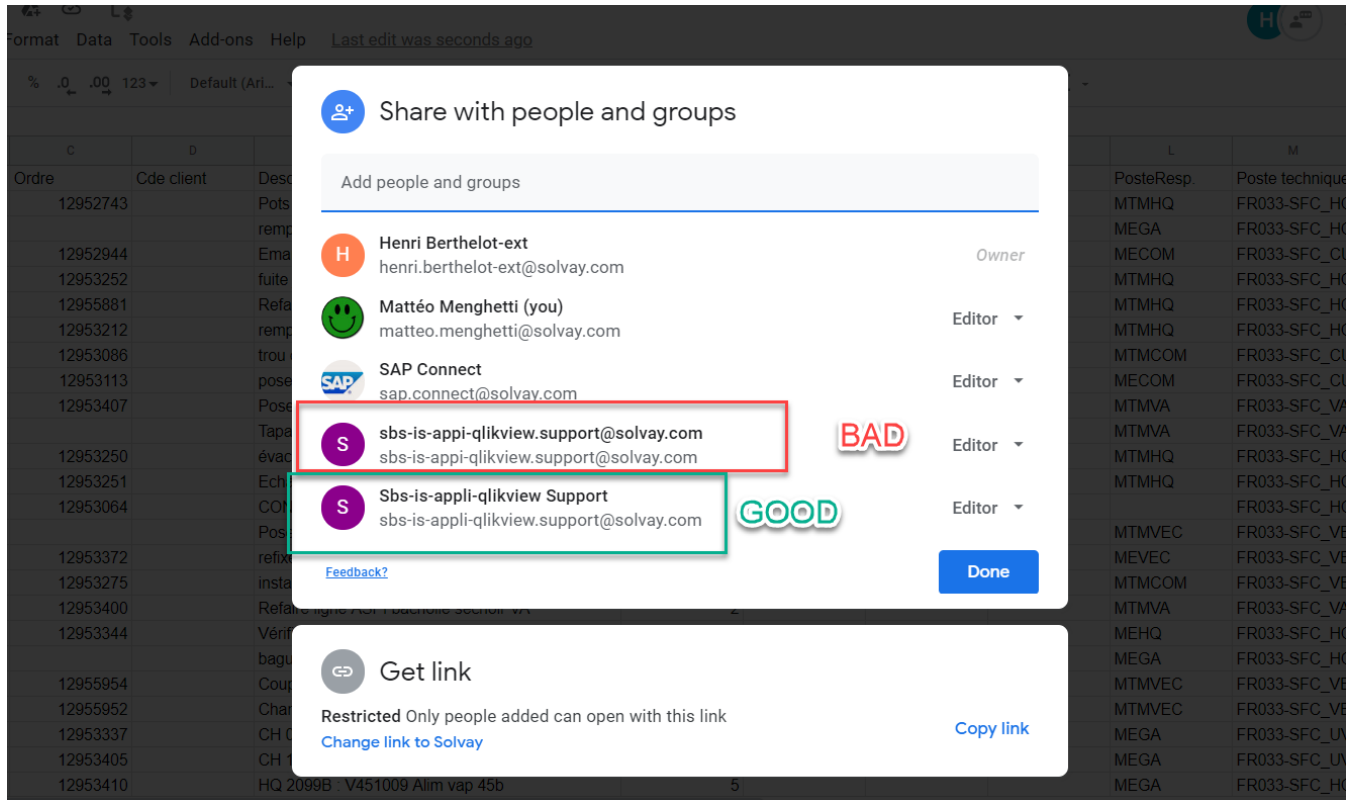

Warning : Be careful to have all different column names in your Spreadsheet. If two columns have the same name, it will not work !!

- In parallel create go to 'Data Manager' in one of your QlikSense app.

blocked URL

- Go to 'Add Data' on left side

blocked URL

- Or create new app and click on right side of hub page -> choice a name of apps

blocked URL

- Create a new connection on 'Web File'

blocked URL

- Copy path following URL :

http://localhost:5555/data?connectorID=GoogleDriveConnector&table=GetSpreadsheet&worksheetKey= 1JopfGZMeZd4-2FKBQACKACYDgPloaOy_w91sUj4601o %3a_0 &appID=

http://localhost:5555/data?connectorID=GoogleDriveConnector&table=GetSpreadsheet&worksheetKey=1CECuNQAIAYffAWQEIEiuvbgG3NyQcJLRwHHFc3AafE4%3a_957959508&appID=

In blue you have standard URL must be filled for each gSheet source

In green you have dedicated URL depending from your gSheet worksheetKey

URL is splitted in 5 blocs :

1) <http://localhost:5555/data?connectorID=GoogleDriveConnector&table=GetSpreadsheet&worksheetKey=>

2) Your Spreadsheet Key (example 1CECuNQAIAYffAWQEIEiuvbgG3NyQcJLRwHHFc3AafE4)

3) [%3a_](#)

4) Your Worksheet Key (example 957959508)

5) [&appID=](#)

blocked URL

- Click on Create and select desired columns

blocked URL

You have also the possibility to skip First X Rows of your gSheet with parameter [&skipRows=X](#) to add in your URL (at the end for example).

X correspond to the number of rows will be excluded from the output. (For example 1 or 2). By default Qlik Skip 0 rows and the first line is used like Header

(Example [&skipRows=1](#))